



INSTRUCTION MANUAL



LASER STICK VACUUM

TT-LV8



Thank you for buying **LV8** – Laser Stick Vacuum by **TurboTronic®**.

TT-LV8 cordless, rechargeable and powerful vacuum with laser illumination that reveals microscopic dust.

Lightweight and can be used to clean hard to reach areas.

Transforms into a handheld vacuum cleaner allowing a greater use of cleaning options. TT-LV8 offers the power you need to keep your home clean. it cleans bare floors and deep cleans carpets. multi-floor cleaning performance, you can move from room to room, cleaning both hard floors and carpet.



Green laser light reveals microscopic dust

The human eye's evolutionary sensitivity to green light means we see it brighter than other colors, enhancing contrast and making hidden dust clearly visible. A custom lens spreads light into a fan shape, to illuminate fine dust so it stands out from the surface it sits on.

BRAND: TURBOTRONIC	POWER: 120W, 220-240V 50-60Hz
ITEM NUMBER: TT-LV8	QTY.: 1 PCS/CTN
DESCRIPTION: Laser Stick Vacuum	N.W.: 1.8kg
GB PACKAGE SIZE: 645x205x140mm	G.W.: 2.7kg
COLOR: Black	EAN: 4260563037851
COLOR: Red Black	EAN: 4260563037844

IMPORTANT SAFEGUARDS

HOUSEHOLD USE ONLY. READ ALL INSTRUCTIONS.

When using electrical appliance, basic safety precautions should always be followed, including the following: Read this user manual carefully, before you use the appliance, and keep it safely for future reference.





WARNING:

Please store this instruction for future use.

- Do not allow children to play with vacuum cleaners alone.
 - This appliance is only for home use. Do not use it outdoors.
 - When unplugging the charger, please hold the plug and do not pull the power cord.
 - The following objects are strictly prohibited, otherwise, it will damage the vacuum cleaner or cause fire and cause harm to your body:
 - Do not suck large or sharp objects, such as glass, etc.
 - Do not absorb reactive liquids such as: soluble, corrosive, detergent, etc.
 - Do not absorb flammable or explosive objects, such as gasoline, alcohol, etc.
 - Check the equipment or charger frequently to avoid damage.
 - If there is damage on the fuselage or other places, do not continue to use it. Do not turn on the device or charger without permission, do not change the power cord yourself. Please send the machine to the professional maintenance personnel for maintenance. Do not try to repair the machine yourself to avoid injury.
 - When charging the machine, please pay special attention to it, and do not trip the power cord.
 - Keep the power cord away from the hot surface of the object, such as: cooking utensils and other hot objects.
 - Do not touch the charger or power cord with wet hands.
 - When using vacuum cleaner, do not aim the vacuum cleaner at people or animals.
 - Please use the attached provided accessories.
 - Please store this instruction in a safe place.
 - Please only use the Battery Charger which was supplied with this appliance.
- 100–240V~ 50-60Hz 0.5A
Output: 26.0V 500mA
Type: Li-ion, 22.2Vd.c., 2200mAh
- Keep out of reach from children, and physically challenged people.
 - Do not use on any type of liquid.
 - Check if the dust bucket is full frequently, otherwise it will block the HEPA filter and sponge or seriously damage the vacuum cleaner.



Indicates to read and review instructions to understand operation and use of product.

	<p>Indicates the presence of a hazard that can cause personal injury, death or substantial property damage if the warning included with this symbol is ignored.</p>
	<p>Take care to avoid contact with hot surface. Always use hand protection to avoid burns.</p>
	<p>For indoor and household use only.</p>

DESCRIPTION OF THE DEVICE

1. On/off button
2. Dust canister release button
3. Tube release button
4. Tube
5. Brush release button
6. Main brush
7. Dust canister empty button
8. Dust canister
9. Wall mounting
10. 2 in 1 tool
11. Charger

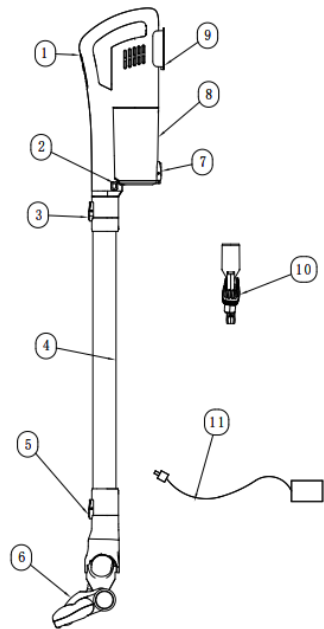

CHARGE THE BATTERY

Notes: The charging base should be fixed on smooth and solid walls. Make sure to use the original charger.

Indicator description when discharging:

1. When using the vacuum cleaner, the battery pack indicator lights are on; when the battery is about to run out, the battery pack indicator lights flash and then off.
2. When the battery is completely exhausted and all the indicator lights are off, the machine needs to be charged.

USAGE AND FUNCTION:

Operating the Machine

Notes:

Do not use this product when charging.

Please always check whether there are foreign matters in the flat suction. If there are foreign matters, your floor may be scratched.

1. Insert the 2in1 tool into the host machine to clean the table, the interior of the car, corners, etc.

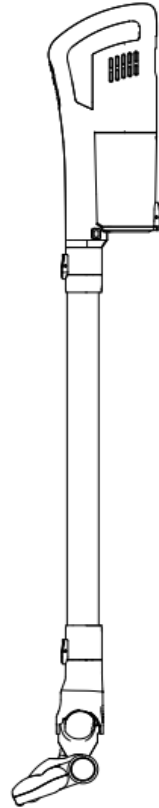
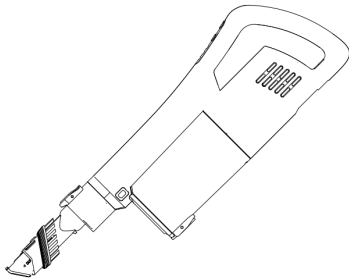

2. Connect the aluminum tube and the floor brush assembly to the host, which can be used to clean the floor, carpet, etc.
3. Press the switch button to start the machine to turn on the vacuum cleaner.
4. Press the switch button again to turn off the machine.

CLEANING YOUR MACHINE

Please drop off the dust in the bucket and clean the steel mesh filter and sponge.

1. Press the ash dumping button to dump the garbage in the dust bin.

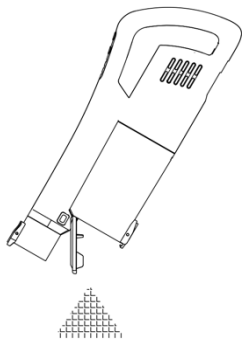

2. Remove the filter.

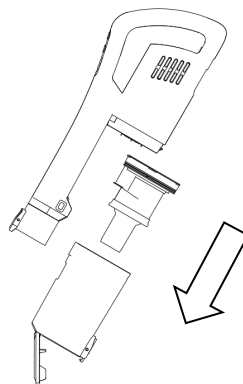

3. Clean the dust bucket. Rinse sponge and steel mesh filter with water and dry them in the ventilated place.

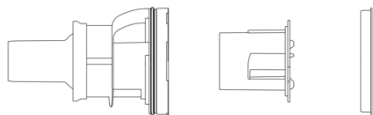

4. Put the sponge and steel mesh filter back into the dust bucket after they dry.

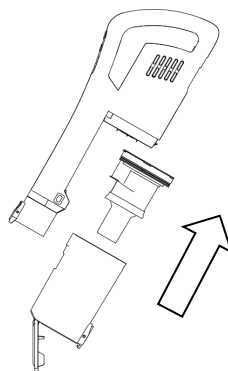

5. Fasten the bottom cover of dust cylinder upward.

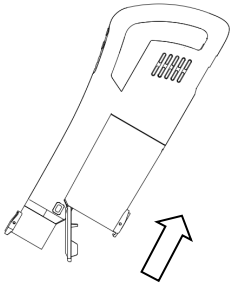

6. Ready for work

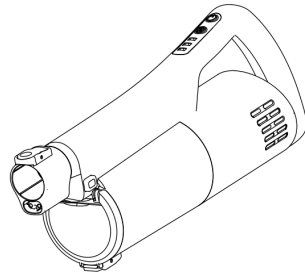

Important: Make sure the steel mesh filter and, sponge and dust buckets are completely dry before you install them.

When the item is stop working and the green light goes off

Remove the floor brush and press the lock button to remove the roller brush

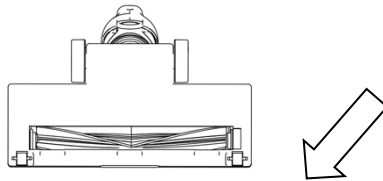

1. Cut off the hair on the roller brush with scissors and remove it

2. The functions of the left and right sides of the roller brush are different. Install the roller brush according to the actual structure and lock it.

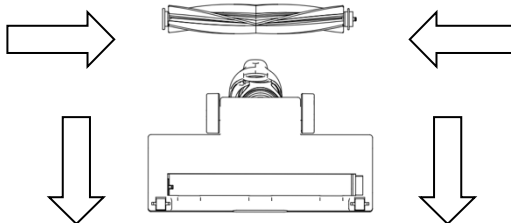

DEAL WITH WASTE BATTERIES

When discarding the device, remove the battery from the device first. Don't mix waste batteries with daily garbage

Put them together; The battery should be sent to the local authoritative recycling center.

If you can't remove the battery yourself, the local recycling center will help you remove it.

REPAIRMENT

When the product is broken, please let the professional personnel repair it.

TECHNICAL DATA

Power adapter	Input: 100-240V~50/60 Hz 0.5 A Output: 26.0Vd.c., 500mA
Wattage	160W
Battery type	Li-ion, 22.2Vd.c. 2200mAh
Charging time	4-5hours
Working time and vacuum (on full charge)	first speed:5kpa 40min second speed: 7kpa 30min third speed: 10kpa 20min

DISPOSAL OF OLD ELECTRICAL APPLIANCES:



The European directive 2002/96/EC on Waste Electrical and Electronic Equipment (WEEE), requires that old household electrical appliances must not be disposed of in the normal unsorted municipal waste stream. Old appliances must be collected separately in order to optimize the recovery and recycling of the materials they contain, and reduce the impact on human health and the environment. The crossed out “wheeled bin” symbol on the product reminds you of your obligation, that when you dispose of the appliance, it must be separately collected. Consumers should contact their local authority or retailer for information concerning the correct disposal of their old appliance.

LIMITED WARRANTY:

Limited Warranty applies to purchases made from authorized retailers of **TurboTronic®**.

TurboTronic® Warranty coverage applies to the original owner and to the original product only and is not transferable.

TurboTronic® warrants that the unit shall be free from defects in material and workmanship. Limited Warranty apply only when it is used under normal household conditions and maintained according to the requirements outlined in the Owner's Guide, subject to the following

conditions and exclusions:

ANY WARRANTY OR AFTER PURCHASE SERVICE, SHOULD BE WITH A THIRD-PARTY COMPANY, FROM WHICH YOU PURCHASED THE PRODUCT. TURBOTRONIC® PROVIDES THE WARRANTY ONLY TO OUR THIRD-PARTY SUPPLIERS. SINCE THIS PRODUCT IS NOT PURCHASED DIRECTLY FROM TURBOTRONIC® BUT THROUGH ONE OF OUR THIRD-PARTY SUPPLIERS, ANY ISSUE AFTER THE PURCHASE, CUSTOMER SERVICE OR RECEIVING THE WARRANTY SHOULD BE ONLY / DIRECTLY THROUGH THE THIRD-PARTY SUPPLIERS FROM WHICH YOU PURCHASED THE PRODUCT.

What is covered by this warranty?

1. The original unit and/or non-wearable parts deemed defective, in **TurboTronic®** sole discretion, will be repaired or replaced
2. **TurboTronic®** reserves the right to replace the unit with one of equal or greater value.

What is not covered by this warranty?

1. Normal wear and tear of wearable parts (such as blending vessels, lids, cups, blades, blender bases, removable pots, racks, pans, etc.), which require regular maintenance and/or replacement to ensure the proper functioning of your unit, are not covered by this warranty.
2. Any unit that has been tampered with or used for commercial purposes.
3. Damage caused by misuse, abuse, negligent handling, failure to perform required maintenance (e.g., failure to keep the well of the motor base clear of food spills and other debris), or damage due to mishandling in transit.
4. Consequential and incidental damages.

5. Defects caused by repair persons not authorized by **TurboTronic®**. These defects include damages caused in the process of shipping, altering, or repairing the **TurboTronic®** product (or any of its parts) when the repair is performed by a repair person not authorized by **TurboTronic®**.

6. Products purchased, used, or operated outside Europe.

Illustrations may differ from actual product.

We are constantly striving to improve our products, therefore the specifications contained herein are subject to change without notice.

TurboTronic® and **Z-Line®** are registered trademarks of **Z-GLOBAL B.V.B.A®**.

PRINTED IN PRC