



INSTRUCTION MANUAL



Cordless cyclonic vacuum cleaner
TT-C26

www.zline-world.com



- Device Description
- Special safety instructions
- Mount the wall bracket
- Assembly of the vacuum cleaner
- Charge the battery
- Installation
- Empty the dust container
- Cleaning
- Troubleshooting
- Important safety instructions
- Disposal and guarantee
- Technical specifications

Dear Customer

We congratulate you on the purchase of this **TurboTronic** practical cordless cyclonic vacuum cleaner, which thanks to the 2 in 1 nozzle, the floor nozzle and the suction pipe, allows you to vacuum even hard-to-reach places easily and wirelessly.

Please read these operating instructions carefully before installation and commissioning in order to familiarize yourself with your new device and to achieve maximum operational safety. In particular, the safety regulations must be observed to avoid accidents and damage. We recommend that you keep the instructions carefully for future reference.

Description of the device

- | | |
|----|--|
| 1 | Suction power button |
| 2 | ON/OFF button |
| 3 | Motor unit |
| 4 | Release button for suction pipe or Nozzle / brush in manual suction mode |
| 5 | Suction pipe |
| 6 | Release button for floor nozzle |
| 7 | Electric floor nozzle |
| 8 | Dust containers |
| 9 | Battery charge status indicator |
| 10 | Open button the dust container flap |

- 11 HEPA filter and cyclone insert
- 12 2 in 1 Crevice nozzle
- 13 Battery
- 14 Release button to remove the battery
- 15 Screws for wall bracket
- 16 Charger (mains adapter)
- 17 Wall bracket
- 18 Mattress brush

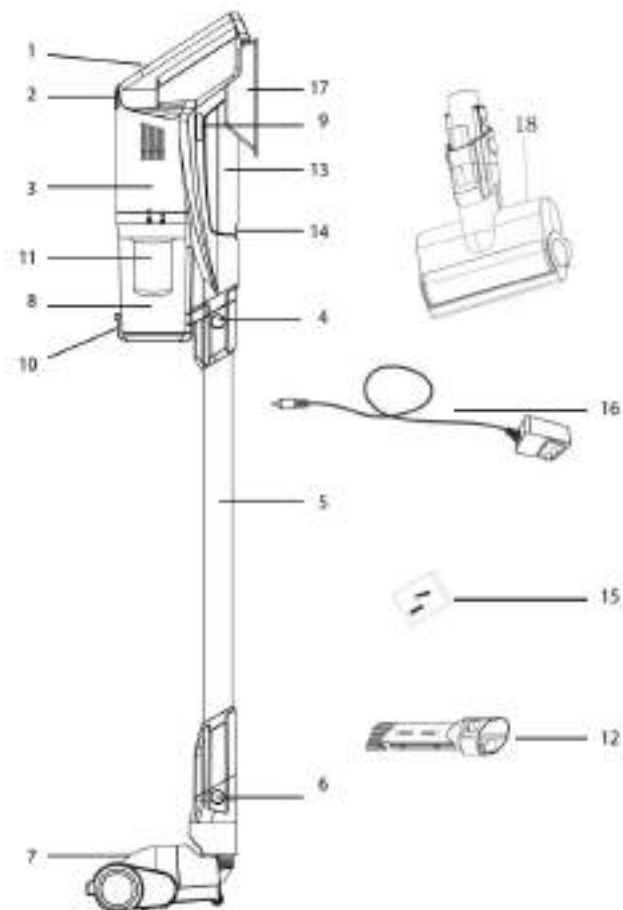

Note on the 2 in 1 crevice nozzle:

- As a nozzle without a brush, ideal for vacuuming sofa cracks, corners, stairs, etc.
- Ideal as a nozzle with a brush for vacuuming furniture, bookshelves, smooth surfaces.

SPECIAL SAFETY INSTRUCTIONS FOR YOUR CYCLE CLEANER

-Keep the device away from heaters, fire or flames or cigarettes.

- If the air intake opening is blocked or the suction pipe or a nozzle or brush is blocked, you must switch the vacuum cleaner off immediately with the ON / OFF button.

Remove the reason for the blockage before you switch the device on again.

- Do not vacuum up large or pointed objects. Therefore, you should remove these objects from the floor before vacuuming. Do not vacuum any flammable or burning / glowing substances (e.g. cigarette ends) or liquids.
- Only operate the vacuum cleaner with the correctly installed cyclone insert and HEPA filter.
- Empty the dust container regularly.
- Charge the battery every 3 months, even if the device has not been put into operation, to protect against deep discharge (see note "Periodic charging of the battery").

INSTALL THE WALL SUSPENSION

1. Screw the wall bracket (17) with the screws at a suitable height on the wall, it should be installed near an electrical outlet.
2. The device's suspension device is located on the rear of the motor handle.
3. Hang the cyclone suction device on the hanging device on the wall mounting.



ASSEMBLY OF THE VACUUM CLEANER

1. Insert the filter in the dust container
 - a. Place the cyclone insert in the dust container. Align the pins in the cyclone insert with the cutouts in the dust container.
 - b. Place the HEPA filter in the cyclone insert.

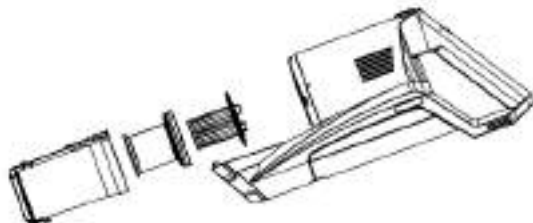

2. Install the dust container in the motor unit
 - a. Place the dust container on the pins at the bottom of the motor unit.
 - b. Push the dust container inwards so that it clicks into place.

3. Attach the battery to the motor unit
 - a. Snap the battery into the battery compartment and then push it into the motor unit until you hear a click.

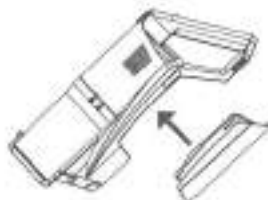

4. Mount the suction pipe and floor nozzle on the motor unit
 - a. Push the floor nozzle into the lower opening of the suction pipe until it clicks into place.
 - b. Press the suction pipe into the connection opening of the motor unit until it clicks into place.



Note: You can also insert the floor nozzle directly into the connection opening

of the motor unit until it clicks into place.



Remove suction pipe and floor nozzle

To disconnect the intake manifold from the motor unit: press the upper release button (4).

To remove the floor nozzle from the suction pipe: press the lower unlocking button (6).

5. Mount the 2 in 1 nozzle on the device

a. Cyclone vacuum cleaner as a hand vacuum cleaner

use: 2 in 1 nozzle directly into the connection opening of the motor unit until it clicks in with one click engaged.

b. Use a 2 in 1 nozzle with a suction pipe: Insert the nozzle into the lower opening of the suction pipe until it clicks into place. This variant is ideal for vacuuming ceilings or narrow stairs.

To remove, press the release button and remove the nozzle.



6. Mount the mattress brush on the device

The mattress brush directly into the connection opening of the motor unit until it clicks into place.

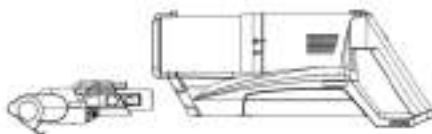

CHARGE THE BATTERY

STEP 1

Use only the supplied AC adapter as a charger for the battery. Hang the assembled vacuum cleaner on the wall mounting, the battery is in the motor unit.

STEP 2

Insert the charger plug into the device socket Insert the charger plug into an electrical outlet. The top light of the battery indicator flashes during charging. Charge the battery with the charger for 4 - 5 hours before using the vacuum cleaner.

Warning: Always keep the battery and charger dry. For charging, the battery must always be in the device, never removed.

STEP 3

As soon as four bars light up in the charging status display (9), the battery is fully charged and the device can be put into operation.

ARENTION:

Do not leave the cyclone vacuum permanently connected to the charger! Pull out the power plug from the socket and the plug from the device as soon as all four bars light up. This saves energy and extends the life of your device. As soon as the suction power drops, charge the device immediately.

IMPORTANT: PERIODIC CHARGING OF THE BATTERY

To prevent deep discharge, the battery must be charged every 3 months even when not in use. Failure to follow this procedure will void the warranty on the battery. Our technical service can determine whether a battery is deeply discharged.

INSTALLATION

- Charge the battery for 4-5 hours with the charger until four bars light up in the charging status display. Always fully charge the device before using it for the first time and after a long period of non-use. Then pull out the mains plug.
- If the cyclone insert with HEPA filter is in the motor unit and installed together with the dust container, you can start up the vacuum cleaner.
- Mount the suction pipe or the appropriate nozzle or brush as described.
- Press the ON / OFF button (2) to switch on the vacuum cleaner.
- With the suction power button (1) you can set the suction power: high or low.

- If you want to change the nozzles or brushes, always switch off the device with the ON/OFF button.

EMPTY DUST CONTAINER

- When the dust container is full, you should empty it to maintain full suction power.
 - The device must be switched off beforehand and the battery removed from the motor unit (press the release button (14)) before emptying the dust container.
1. Turn the dust container to separate it from the motor unit.
 2. Hold the flap of the dust container over a waste bin and press the button (10) to open the flap. Empty dust and dirt.
 3. Close the flap again so that it clicks into place. Put the empty dust container back into the device.

CLEANING THE DUST CONTAINER, THE CYCLONE INSERT AND THE FILTER

From time to time you should remove and clean the dust container and the cyclone insert with HEPA filter, at the latest when you notice that the suction power is deteriorating. Switch off the device with the ON / OFF button and remove the battery.

1. Turn the dust container (8) and remove it from the device. Empty it as described in the chapter "Emptying the dust container".
 2. Take the cyclone insert and the HEPA filter out of the dust container.
 3. Knock out the cyclone insert and the HEPA filter or clean them with a brush.

4. You can also clean the cyclone insert and the HEPA filter under lukewarm water. Allow both to air dry completely before reinstalling them.
5. Rinse the dust container under lukewarm water, dry it with a soft cloth and then let it air dry completely.
6. Then put all the parts back into the device and close the flap so that it engages. Attention: The device may only be put into operation if the dry cyclone insert and HEPA filter are correctly inserted again and the dust container is inserted.

CLEANING THE VACUUM CLEANER

- When the device is switched off and disconnected from the charger, you can wipe the device with a dry cloth.
- Do not use abrasive rags, steel wool, abrasive cleaners, acetone or alcohol.
- Never immerse the vacuum cleaner in water.
- Store the device in a dry, cool place out of the reach of children.

CLEAN THE ELECTRIC FLOOR NOZZLE

Hair and lint can get caught in the brush, which must be removed from time to time so that the suction power does not deteriorate.

1. Slide the button on the bottom of the floor nozzle to the left and remove the cover.
 2. Remove the cylinder brush. Use scissors to cut the hair and lint caught in the cylinder brush and remove them.
-
3. After cleaning, put the cylinder brush back in the nozzle, put the cover on it and push the button to the right again.

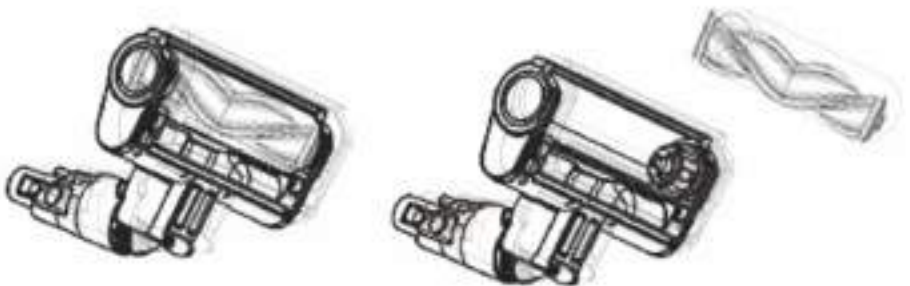

PROBLEM SOLVING

PROBLEM	POSSIBLE CAUSE	PROBLEM SOLVING
Vacuum cleaner doesn't work. Vacuum cleaner cannot be switched on.	-The battery is empty. The battery is being charged.	<ul style="list-style-type: none"> • Charge the battery with the charger. • Disconnect the device from the charger as soon as the charging process is complete.
Suction power is low or nonexistent	<ul style="list-style-type: none"> • The dust container is full. The cyclone insert and filter must be cleaned. • The air intake is blocked. • The battery is weak. 	<ul style="list-style-type: none"> • Empty the dust container. • Clean the cyclone insert and filter and insert correctly. • Check air intake for possible blockage and remove blockage. • Charge the battery with the charger.
Dust escapes from the device.	<ul style="list-style-type: none"> • The dust container is full. • Cyclone insert and filter are not inserted correctly. 	<ul style="list-style-type: none"> • Empty the dust container. • Insert the cyclone insert and filter correctly.
Battery does not charge.	The battery needs to be replaced.	Contact your point of sale.
Unusual noises while sucking.	<ul style="list-style-type: none"> • The dust container is full. • Floor nozzle blocked by hair and lint. 	<ul style="list-style-type: none"> • Empty the dust container. • Remove and clean the floor nozzle.

IMPORTANT SAFETY INSTRUCTIONS

In order to avoid injuries caused by electricity such as electric shock, short circuit or fire, we ask you to always observe the following safety regulations:

- Make sure that you never touch the live parts! Electric shock can result in serious injury or even death.
- Only connect the charger to an AC outlet with a voltage of 230 V/50 Hz. The minimum fuse protection for the socket is 6 amps. The socket should be

secured with a residual current circuit Please be sure to observe the applicable local ordinances and regulations.

- The device must never be operated without supervision, charged or used for other purposes. Use only the accessories supplied with this vacuum cleaner.
- Never use this device to vacuum water, liquids, flammable or explosive substances or materials, burning or hot ashes, matches, cigars or dust or substances harmful to health.
 - Never powder-like substances such as Soak in flour. Danger of engine damage!
 - Never pick up pointed or sharp objects, e.g. Nails, needles etc.
 - Never cover the device while it is in operation.
- Never store or place the device near heat sources such as an oven, stove, heating or heat-emitting devices. Never use the device in potentially explosive areas. Protect the battery from heat and use and store at temperatures between 0°- 40°C.
- Never place the device near bathtubs, swimming pools or containers filled with water where there is a risk of it falling into the water. Electric shock!
 - Never immerse the vacuum cleaner or charger in water!
 - Only clean the device with a dry cloth.
- Do not use or store the device outdoors. Never expose the vacuum cleaner or battery to moisture or rain or bring it into contact with water. Never vacuum wet surfaces. The device should not be exposed to the sun for long periods.
- Always fully charge the battery before using it for the first time or after a long period of non-use. If you do not want to use the device for a long time, the battery must still be charged every 3 months (see note "Periodic charging of the battery").
- As soon as the battery is fully charged, the mains plug of the charger/ mains adapter must be pulled out of the socket.
- Keep suction openings and nozzles or brushes away from the face and body, as well as from hair, jewelry and clothing.
- Only use the device with a dry and correctly installed cyclone insert and HEPA filter as well as the dust container.
- If you attach or remove accessories, the device must be disconnected from the charging station.
- Improper repairs or handling can result in considerable risks for the user and the environment. We accept no liability for damage caused by incorrect use,

non-compliance with local safety regulations, or use other than that specified in this manual.

Specification

Model: TT-C26	Brand: TurboTronic®
Working voltage: 22.2Vdc	Charging time: 4-5 hours
Power: 120W	Net Weight: 2.7kg
Adapter Input Voltage: AC100-240V 50/60Hz	Production Dimension(L*W*H): 250*190*1150mm
Battery type: Li-ion Battery Pack	Filtration Type: HEAP

Disposal of old electrical appliances

The European directive 2002/96/EC on Waste Electrical and Electronic



Equipment (WEEE), requires that old household electrical appliances must not be disposed of in the normal unsorted municipal waste stream. Old appliances must be collected separately in order to optimize the recovery and recycling of the materials they contain, and reduce the impact on human health and the environment.



The crossed out “wheeled bin” symbol on the product reminds you of your obligation, that when you dispose of the appliance, it must be separately collected.

Consumers should contact their local authority or retailer for information concerning the correct disposal of their old appliance.

LIMITED WARRANTY

Limited Warranty applies to purchases made from authorized retailers of

TurboTronic®.

TurboTronic® Warranty coverage applies to the original owner and to the original product only and is not transferable.

TurboTronic® warrants that the unit shall be free from defects in material and workmanship. Limited Warranty apply only when it is used under normal household conditions and maintained according to the requirements outlined in the Owner's Guide, subject to the following conditions and exclusions:

What is covered by this warranty?

1. The original unit and/or non-wearable parts deemed defective, in **TurboTronic®** sole discretion, will be repaired or replaced
2. **TurboTronic®** reserves the right to replace the unit with one of equal or greater value.

What is not covered by this warranty?

1. Normal wear and tear of wearable parts (such as blending vessels, lids, cups, blades, blender bases, removable pots, racks, pans, etc.), which require regular maintenance and/or replacement to ensure the proper functioning of your unit, are not covered by this warranty.
2. Any unit that has been tampered with or used for commercial purposes.
3. Damage caused by misuse, abuse, negligent handling, failure to perform required maintenance (e.g., failure to keep the well of the motor base clear of food spills and other debris), or damage due to mishandling in transit.
4. Consequential and incidental damages.
5. Defects caused by repair persons not authorized by **TurboTronic®**. These defects include damages caused in the process of shipping, altering, or repairing the **TurboTronic®** product (or any of its parts) when the repair is performed by a repair person not authorized by **TurboTronic®**.
6. Products purchased, used, or operated outside Europe.

Illustrations may differ from actual product.

We are constantly striving to improve our products, therefore the specifications contained herein are subject to change without notice.

TurboTronic® and **Z-Line®** are registered trademarks of **Z-GLOBAL B.V.B.A®**.

PRINTED IN PRC