

**TurboTronic**  
House Electronics

# VS<sup>mach</sup>280

## INSTRUCTION MANUAL

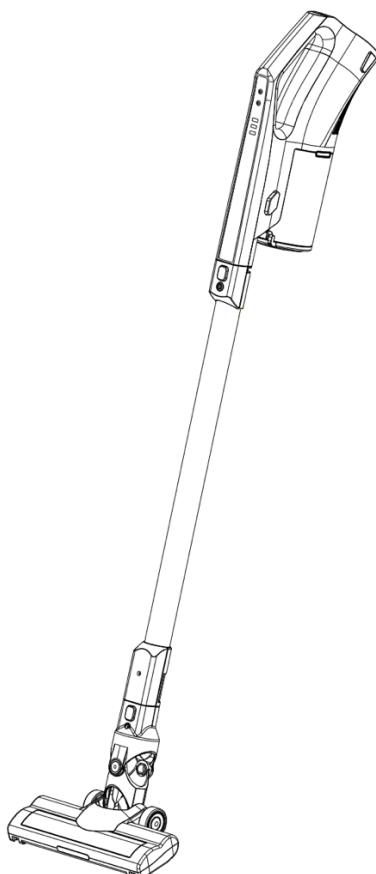

**TT-VS280**





**STICK VACUUM**



## SAFETY ADVICE & CAUTIONS

### Read all the instructions carefully before using the vacuum cleaner

- This vacuum cleaner can only be used on dry purpose only. Water, liquid and other wet objects are prohibited to be sucked into the product. Do not water or spill liquid onto the vacuum cleaner. If that happens, it will increase the risk of electric shock.
- Do not use the vacuum cleaner to suck powders such as flour, cement or other big objects, or the motor can be broken or make the vacuum cleaner blocked.
- Please use dry cloth to clean the vacuum cleaner. Please do not use gas or liquid that can make the surface cracked or color faded such.
- Please do not use or store the vacuum cleaner under high or low temperature, suggested using temperature is 0° -40° C indoor. Please store the product under cool and dry environment. Please avoid long-time sunshine on the product.
- Please fully recharge the battery, when first used or used after long time storage. If the product is not used for long time, please make sure the battery is recharged and used each three months at least.
- When the vacuum cleaner fully recharged, please unplug the adaptor. Please do not pull the power cord directly.
- When working time goes shorter, caused by low battery capacity, please buy new battery unit to replace it.
- Do not litter the battery unit and it should be safely recycled.
- Battery unit can only use for this vacuum cleaner, please do not use it on other purposes, and can only charge with the adaptor with the vacuum cleaner in the package, do not disassemble the battery unit in case of damaging or short circuit. Do not place the battery unit close to the high temperature objects or fire, do not insert the battery unit with sharpen objects or break the battery in case of electric shock.
- If the vacuum cleaner cannot work or some parts broken, in order to avoid dangers, please do not disassemble it privately, sent it to the appointed maintenance or service center and get it repaired by professional after sales
- Please make sure the child can not touch or use the vacuum cleaner and charge the battery unit in case of dangers.

	Indicates to read and review instructions to understand operation and use of product.
	Indicates the presence of a hazard that can cause personal injury, death or substantial property damage if the warning included with this symbol is ignored.
	Take care to avoid contact with hot surface. Always use hand protection to avoid burns.
	For indoor and household use only.

# PARTS LIST

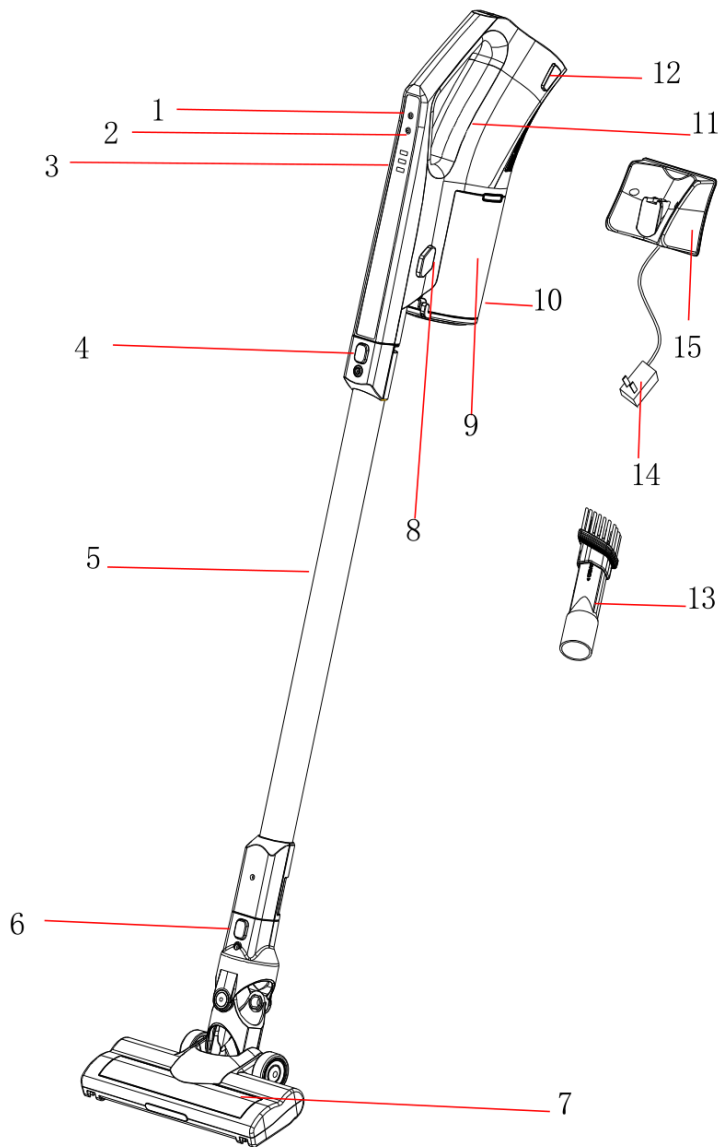

- |                             |  |
|-----------------------------|--|
| 1. On/off                   | 9. Dust tank   |
| 2. Speed control button     | 10. Dust release button                              |
| 3. Battery indicator        | 11. Motor unit                                       |
| 4. Main body release button | 12. Battery unit release button                      |
| 5. Electric tube            | 13. 2-in-1 tool crevice nozzle<br>and dusting nozzle |
| 6. Brush release button     | 14. Adaptor  |
| 7. Power brush              | 15. Wall mounting                                    |
| 8. Dust tank release button |  |

# PACKING LIST

Main unit	Battery unit	Tube	Power brush	Tool
1	1	1	1	1+1
Adaptor	Wall mounting			—
1	1			—

## ASSEMBLING

### ·Assembly dust cup unit

1. Put filters into dust cup, twist the cone and match cone's pins into the grooves inside the dust cup.
2. Insert filter onto the cone

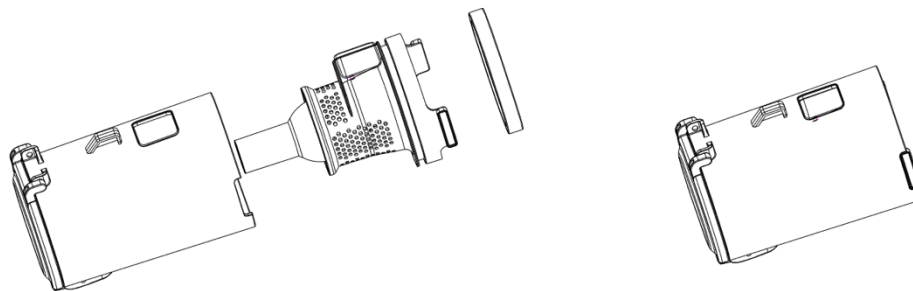

### ·Assembly dust tank with motor unit

1. Put the dust cup to pins on motor unit lower edge
2. Push the dust cup till "Click" sound heard

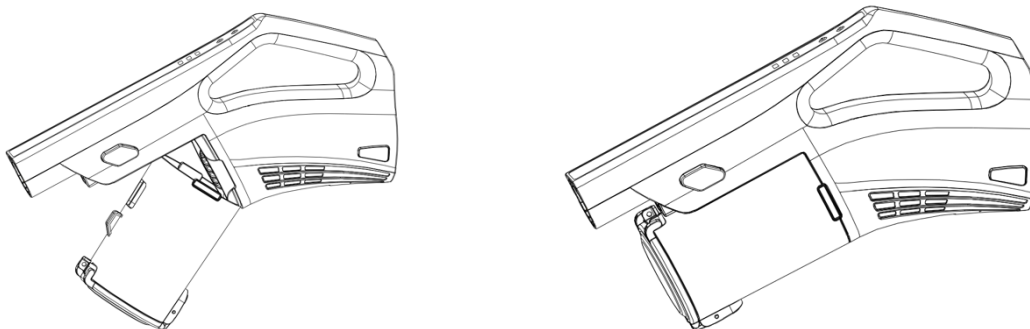

### **·Assemble main unit with battery unit**

1. Press the battery unit onto the main unit. till a “click” sound heard

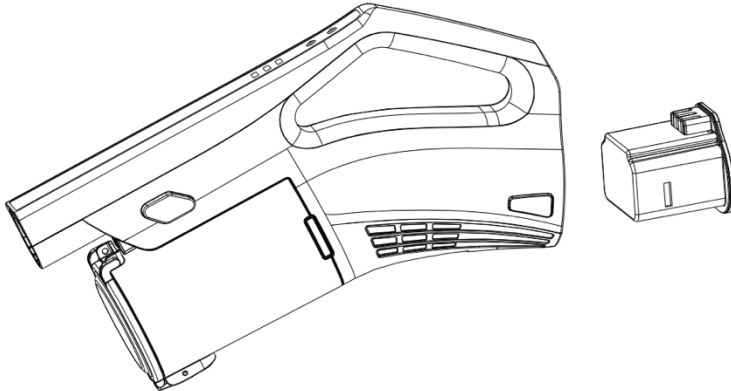

### **·Power brush, tube, and main body assembled**

1. Insert upper end of power brush into lower end of the tube, till a click sound heard
2. Insert the upper end of the tube into the lower end of battery unit a click sound heard

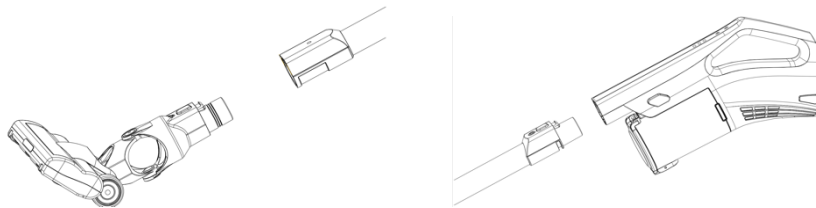

## **HOW TO ASSEMBLE THE ACCESSORIES**

### **·Accessory assembled into the main unit**

- 2 in 1 tool just insert into the main unit hole and make them inserted firmly

### **·Assemble the accessories to the tube.**

Insert the round end of either 2 in 1 tool or furniture tool into the lower end of tube, till a click sound heard

Please refer to picture 8

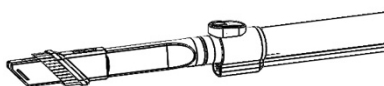

# HOW TO PLACE THE MAIN UNIT

## Wall mounting:

1. Fixed the wall mounting which near with the socket
2. Put the main unit on the wall mounting.

## USING

### ON/OFF

Press the on/off button and speed control button to start the vacuum cleaner, press the button again to adjust the vacuum cleaner work to high/low speed.

### ACCESSORY: 2 IN 1 TOOL

1. Insert 2 in 1 tool into main unit, then push the dusting head back. This form can clean sofa gap, wall corners, stairs, keyboard and other narrow places
2. Insert 2 in 1 tool into main unit, and then push the dusting head back till it is locked. This form can clean furniture, home appliances and bookshelf.
3. Insert 2 in 1 tool into tube and then push the dusting head back till it is locked. Insert the other end of the tube into the main unit. This form can clear roof or other high places.

### Main motorized brush

Connect the brush with tube, then can use the motorized brush to clean.

## Charging

- ✧ Before charging, make sure the adaptor is the right one.
- ✧ Put the vacuum on the wall mounting, when charging, One LED light will be turned on, when fully charged, three LED lights will be turn on.
- ✧ When the battery is going to be power off, please charged it right now with adaptor.

## CLEAN AND STORE

### Empty dust

1. Press the motor unit release button to divide motor unit from battery unit.
2. Release button to empty the dust from the cup.

## Dust cup clean

1. Press the release dust tank button, Take it out.
2. disassemble the dust cup, Get out the HEPA and plastic filter from dust cup.
3. Both HEPA and filters can be washed. After cleaning, dry them naturally

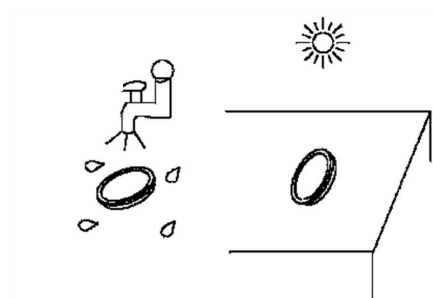

Picture 1o

## -Clean the main brush

1. Glide the knob on brush bottom to left size, lift the brush roll cover
2. Get out of the roll and clean it (no water)

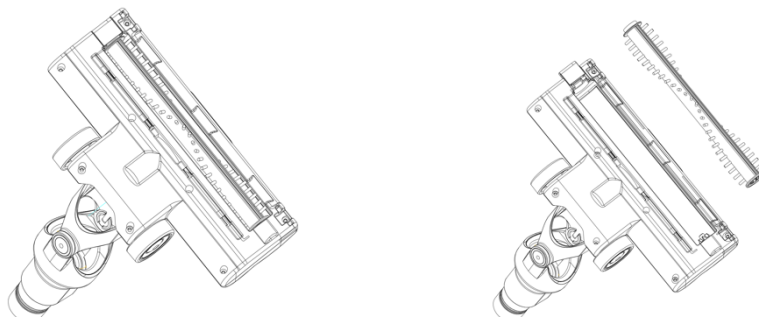

**ATTENTION:** after long time use, the roll may stick hair or other masses which needs to be cleaned in time in order to keep the vacuum cleaner working efficiently.

## TECHNICAL DATA

<b>Model no.</b>	TT-VS280
<b>Nom. Voltage</b>	22.2V
<b>Nom. Input power</b>	120W
<b>Input of adaptor</b>	100-240V~50/60Hz, 0.4A
<b>Output of adaptor</b>	27V, 500mA
<b>Working time</b>	40±5min (normal speed)

## DISPOSAL OF OLD ELECTRICAL APPLIANCES:



The European directive 2002/96/EC on Waste Electrical and Electronic Equipment (WEEE), requires that old household electrical appliances must not be disposed of in the normal unsorted municipal waste stream. Old appliances must be collected separately in order to optimize the recovery and recycling of the materials they contain, and reduce the impact on human health and the environment. The crossed out “wheeled bin” symbol on the product reminds you of your obligation, that when you dispose of the appliance, it must be separately collected. Consumers should contact their local authority or retailer for information concerning the correct disposal of their old appliance.

## LIMITED WARRANTY:

Limited Warranty applies to purchases made from authorized retailers of **TurboTronic®**.

**TurboTronic®** Warranty coverage applies to the original owner and to the original product only and is not transferable.

**TurboTronic®** warrants that the unit shall be free from defects in material and workmanship. Limited Warranty apply only when it is used under normal household conditions and maintained according to the requirements outlined in the Owner’s Guide, subject to the following conditions and exclusions:

**ANY WARRANTY OR AFTER PURCHASE SERVICE, SHOULD BE WITH A THIRD-PARTY COMPANY, FROM WHICH YOU PURCHASED THE PRODUCT. TURBOTRONIC® PROVIDES THE WARRANTY ONLY TO OUR THIRD-PARTY SUPPLIERS. SINCE THIS PRODUCT IS NOT PURCHASED DIRECTLY FROM TURBOTRONIC® BUT THROUGH ONE OF OUR THIRD-PARTY SUPPLIERS, ANY ISSUE AFTER THE PURCHASE, CUSTOMER SERVICE OR RECEIVING THE WARRANTY SHOULD BE ONLY / DIRECTLY THROUGH THE THIRD-PARTY SUPPLIERS FROM WHICH YOU PURCHASED THE PRODUCT.**

### **What is covered by this warranty?**

1. The original unit and/or non-wearable parts deemed defective, in **TurboTronic®** sole discretion, will be repaired or replaced
2. **TurboTronic®** reserves the right to replace the unit with one of equal or greater value.

### **What is not covered by this warranty?**

1. Normal wear and tear of wearable parts (such as blending vessels, lids, cups, blades, blender bases, removable pots, racks, pans, etc.), which require regular maintenance and/or replacement to ensure the proper functioning of your unit, are not covered by this warranty.

2. Any unit that has been tampered with or used for commercial purposes.
3. Damage caused by misuse, abuse, negligent handling, failure to perform required maintenance (e.g., failure to keep the well of the motor base clear of food spills and other debris), or damage due to mishandling in transit.
4. Consequential and incidental damages.
5. Defects caused by repair persons not authorized by **TurboTronic®**. These defects include damages caused in the process of shipping, altering, or repairing the **TurboTronic®** product (or any of its parts) when the repair is performed by a repair person not authorized by **TurboTronic®**.
6. Products purchased, used, or operated outside Europe.

Illustrations may differ from actual product.

We are constantly striving to improve our products, therefore the specifications contained herein are subject to change without notice.

**TurboTronic®** and **Z-Line®** are registered trademarks of **Z-GLOBAL B.V.B.A®**.

PRINTED IN PRC